

# Minetto Elementary

## Procedures for dropping off and picking up students

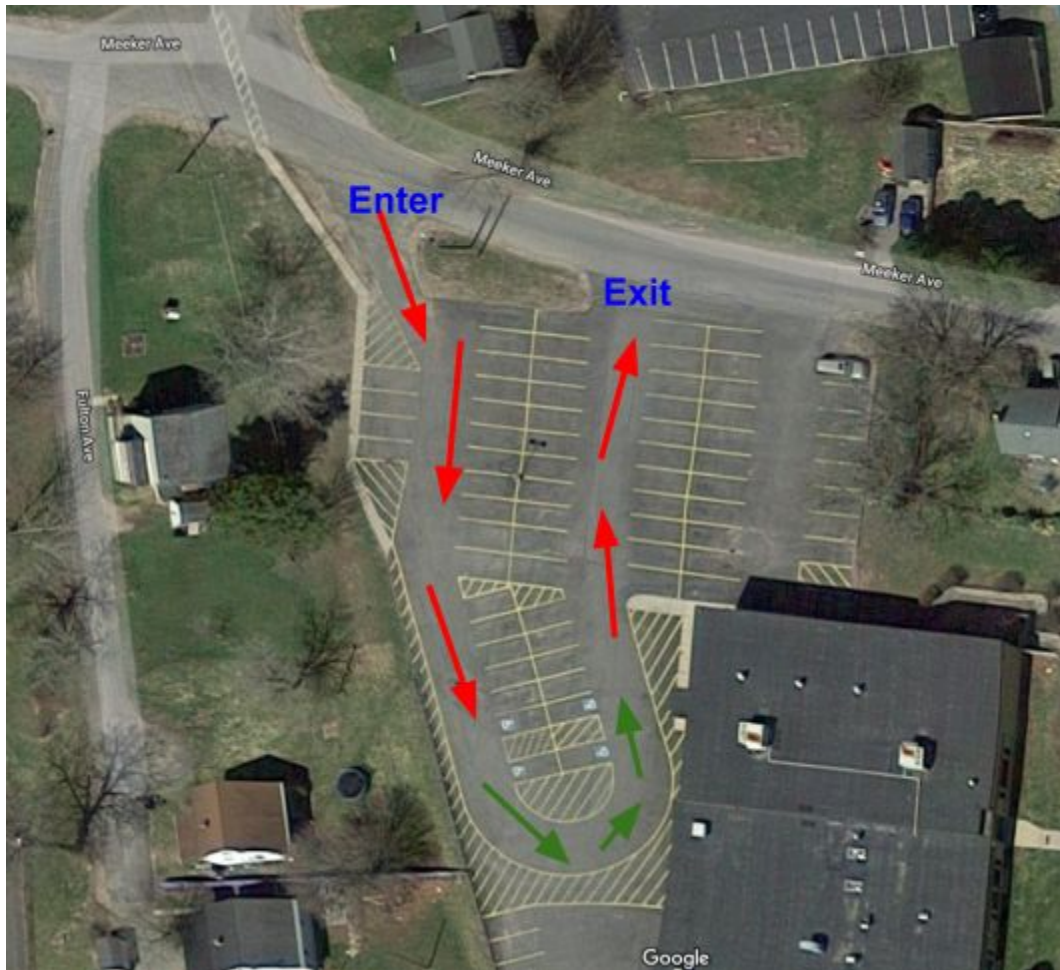

### Parent Drop Off/Pick Up Two options for Arrivals and Dismissals

Stop and Drop (Green Zone)	Park and walk
<ul style="list-style-type: none"> <li>● Adult stays in the car and use the green zone of the “loop”</li> <li>● Children exit or enter the car, from the passenger side, on their own</li> <li>● Traffic continues to move</li> </ul>	<ul style="list-style-type: none"> <li>● Park in a parking space</li> <li>● Use the yellow lined area to walk with your child to or from the main entrance</li> <li>● Wait patiently on the sidewalk area</li> </ul>

To maintain safety during parent drop off and pick up, please review the two options for helping your children enter and exit the Minetto Elementary.

The safety of our students is the most important goal during morning drop-off and afternoon pick-up. We all have a responsibility to see that every child is safe. In addition, we need to keep traffic moving to facilitate student arrival and dismissal in a timely way.

